

TRAFFIC REGULATION ORDER (TRO) CONSULTATION

CHS9038RC – Avenue de Chartres, Sherborne Road, Westgate & Orchard Street, Chichester

8/7/21 – 5/8/21

Contents

Notice	Page 2
Statement of Reasons	Page 4
Draft Order	Page 6
Draft CPE Order	Page 7
Plan "19183_TRO_100_P01" – proposals	Page 8
Plan "19183-WGOS-160-P01" - proposals	Page 9
Plan "c_chichestersu8504nen" – existing restrictions	Page 10
Plan "c_chichestersu8504nen" - proposals	Page 11

WEST SUSSEX COUNTY COUNCIL
((CHICHESTER DISTRICT) (PARKING PLACES AND TRAFFIC REGULATION)
(CONSOLIDATION) ORDER 2010)
(WESTGATE AMENDMENT) ORDER 202
&
WEST SUSSEX COUNTY COUNCIL
(CHICHESTER: AVENUE DE CHARTRES & ORCHARD STREET)
(20MPH SPEED LIMIT) ORDER 2021
&
ROAD TRAFFIC REGULATION ACT 1984 – SECTION 23 &
HIGHWAYS ACT 1980 – SECTION 90 (A), (C) & (D):
CHICHESTER – AVENUE DE CHARTRES, SHERBORNE ROAD, WESTGATE
& ORCHARD STREET ROUNDABOUT
PEDESTRIAN CROSSING PLACES & RAISED HUMPS

NOTICE is hereby given that West Sussex County Council under the provisions of the Road Traffic Regulation Act 1984, Highways (Road Humps Regulations) 1999 and Highways Act 1980, propose to:-

- (i) install five parallel pedestrian/cycle crossing facilities on flat top humps at the new dutch roundabout junction of Westgate, Orchard Street, Avenue de Chartres, North Walls and West Street; and
- (ii) install a parallel pedestrian/cycle crossing on a flat top hump on the Avenue de Chartres 38 metres south of the Tollhouse Close junction; and
- (iii) install a parallel pedestrian/cycle crossing on a flat top hump on Westgate 32 metres east of the Sherborne Road roundabout junction; and
- (iv) install a parallel pedestrian/cycle crossing on a flat top hump on Sherborne Road 15 metres north of the Westgate roundabout junction; and
- (v) install two zebra pedestrian crossing facilities on Sherborne Road one on an extended flat top hump located 16 metres south of the Durnford Close junction and one located 11.5 metres south of the Oak Avenue junction; and
- (vi) install a flat top hump on Westgate Link Road 28 metres south of the Westgate roundabout junction to provide an uncontrolled pedestrian crossing point; and

make permanent Traffic Orders under the provisions of the Road Traffic Regulation Act the effect of which will be to:

- (vii) introduce a loading bay on the north side of Westgate west of the Orchard Street roundabout junction, for loading by any vehicles 8.00am – 5.00pm Monday to Saturday; and
- (viii) introduce a 20mph speed limit on lengths of Avenue de Chartres, Orchard Street roundabout and Orchard Street from the Avenue de Chartres at a point 195 metres south of the Orchard Street roundabout junction, northwards to Orchard Street at a point 30 metres north of the roundabout junction.

The flat top road humps will be constructed from bitumen with each hump being 65 mm above the existing road surface and crossing the entire width of the carriageway.

The overall length of the humps will be 1.125 metres with ramp gradients of 1:17.5.

The consultation for this proposal will start on 8 July 2021 and, AT THAT TIME, full details of the proposal in this Notice can be viewed on our website www.westsussex.gov.uk/tro. The [website](#) includes a response form for comments or objections.

Due to current social distancing requirements, paper copies of documents will not be available to view in council offices or libraries. People without access to a computer who wish to view details of the scheme should telephone the West Sussex County Council Contact Centre on 01243 642105 to receive the documents by post.

Any objections or comments about the proposal must be received by 5 August 2021. These may be sent via the response form on the website, in writing to: TRO Team, West Sussex County Council, The Grange, Tower Street, Chichester, PO19 1RH; or by e-mail to: tro.consultation@westsussex.gov.uk. Library staff will NOT be in a position to answer questions on the proposal and all correspondence should be addressed to the undersigned, quoting the reference TRO/CHS9038/RC. Only correspondence including a full name and address will be considered.

Dated this 8 July 2021

Director of Law & Assurance
County Hall
Chichester

WEST SUSSEX COUNTY COUNCIL
((CHICHESTER DISTRICT) (PARKING PLACES AND TRAFFIC REGULATION)
(CONSOLIDATION) ORDER 2010)
(WESTGATE AMENDMENT) ORDER 202*
&
WEST SUSSEX COUNTY COUNCIL
(CHICHESTER: AVENUE DE CHARTRES & ORCHARD STREET)
(20MPH SPEED LIMIT) ORDER 2021
&
ROAD TRAFFIC REGULATION ACT 1984 – SECTION 23 &
HIGHWAYS ACT 1980 – SECTION 90 (A), (C) & (D):
CHICHESTER – AVENUE DE CHARTRES, SHERBORNE ROAD, WESTGATE
& ORCHARD STREET ROUNDABOUT
PEDESTRIAN CROSSING PLACES & RAISED HUMPS

Statement of Reasons for proposing to make the Orders & install the
crossings and raised humps

The County Council in exercise of their powers under the provisions of the Road Traffic Regulation Act 1984, Highways (Road Humps Regulations) 1999 and Highways Act 1980, propose to:-

- (i) install five parallel pedestrian/cycle crossing facilities on flat top humps at the new dutch roundabout junction of Westgate, Orchard Street, Avenue de Chartres, North Walls and West Street; and
- (ii) install a parallel pedestrian/cycle crossing on a flat top hump on the Avenue de Chartres 38 metres south of the Tollhouse Close junction; and
- (iii) install a parallel pedestrian/cycle crossing on a flat top hump on Westgate 32 metres east of the Sherborne Road roundabout junction; and
- (iv) install a parallel pedestrian/cycle crossing on a flat top hump on Sherborne Road 15 metres north of the Westgate roundabout junction; and
- (v) install two zebra pedestrian crossing facilities on Sherborne Road one on an extended flat top hump located 16 metres south of the Durnford Close junction and one located 11.5 metres south of the Oak Avenue junction; and
- (vi) install a flat top hump on Westgate Link Road 28 metres south of the Westgate roundabout junction to provide an uncontrolled pedestrian crossing point; and

make permanent Traffic Orders under the provisions of the Road Traffic Regulation Act the effect of which will be to:

- (vii) introduce a loading bay on the north side of Westgate west of the Orchard Street roundabout junction, for loading by any vehicles 8.00am – 5.00pm Monday to Saturday; and
- (viii) introduce a 20mph speed limit on lengths of Avenue de Chartres, Orchard Street roundabout and Orchard Street from the Avenue de Chartres at a point 195 metres south of the Orchard Street roundabout junction, northwards to Orchard Street at a point 30 metres north of the roundabout junction.

The flat top road humps will be constructed from bitumen with each hump being 65 mm above the existing road surface and crossing the entire width of the carriageway.

The overall length of the humps will be 1.125 metres with ramp gradients of 1:17.5.

Permission has been granted for a development on land west of Chichester known as Whitehouse Farm. The development will include new homes, community centre, medical centre, primary school and recreational spaces.

The primary access will be from the new roundabout junction on Old Broyle Road.

To help support a modal shift towards more sustainable transport and promote priority for pedestrians and cyclists a raft of highway improvements are being introduced on the existing highway network in the vicinity to provide sustainable transport links from the new development site to the city centre. This includes the provision of a number of signalised crossing points to reduce vehicle speeds and improve road safety for other road users and a dutch style roundabout junction giving pedestrians and cyclists priority over motorists.

The provision of the dutch roundabout junction will require an extension to the existing 20mph speed limit in Chichester City centre to include lengths of the Avenue de Chartres and Orchard Street as well as the designation of a loading bay in Westgate.

These proposals are to facilitate the highway works associated with Phase 1 of this development.

This Order is proposed so as to avoid danger to persons or other traffic using the road or to prevent the likelihood of any such danger arising, for improving the amenity of the area through which the roads run and for facilitating the passage on the road of any class of traffic (including pedestrians)

Drawing Nos. TRO-100 Sherborne Road Traffic Orders and WGO8-160 Westgate/Orchard Street Proposed Dutch Style Roundabout 20mph Traffic Regulation Order & Plan SU8504NEN show the lengths of roads, which are the subject of the proposed orders.

Director of Law & Assurance
County Hall
Chichester

June 2021

WEST SUSSEX COUNTY COUNCIL
(CHICHESTER: AVENUE DE CHARTRES & ORCHARD STREET)
(20MPH SPEED LIMIT) ORDER 2021

West Sussex County Council in exercise of their powers under Sections 82 and 84 (1) (a) of the Road Traffic Regulation Act 1984 ("the Act"), and Part IV of Schedule 9 of the Act and of all other enabling powers, and after consultation with the chief officer of police in accordance with Part III and Part IV of Schedule 9 to the Act hereby make the following Order:-

1. This Order shall come into operation on the x day of x 2021 and may be cited as "West Sussex County Council (Chichester: Avenue de Chartres & Orchard Street) (20mph Speed Limit) Order 2021"
2. No person shall cause or permit any vehicle to proceed at a speed exceeding 20 miles per hour in the length of road specified in the First Schedule to this Order
3. Nothing in Paragraph 2 shall apply to a vehicle being used by naval, military or air force purposes while being driven by a person for the time being subject to the orders of a member of the armed forces of the Crown on an occasion when –
 - (a) the person driving the vehicle is a member of the special forces as defined by the Road Traffic Exemptions (Special Forces) (Variation and Amendment) Regulations 2011; and
 - (b) the vehicle is being driven-
 - (i) in response, or for practice in responding, to a national security emergency by a person who has been trained in driving vehicles at high speeds; or
 - (ii) for the purpose of training a person in driving vehicles at high speeds.

FIRST SCHEDULE
(20mph Speed Limit)

Length of road in Chichester

Avenue de Chartres/Orchard Street

From a point 195 metres south of the Orchard Street roundabout junction, northwards to a point 30 metres north of the Orchard Street roundabout junction.

The COMMON SEAL of WEST SUSSEX)
COUNTY COUNCIL was)
affixed hereto the)
day of)
in the presence of:)(L.S.)
)
)
Authorised Signatory)

WEST SUSSEX COUNTY COUNCIL
((CHICHESTER DISTRICT) (PARKING PLACES AND TRAFFIC
REGULATION)
(CONSOLIDATION) ORDER 2010)
(WESTGATE AMENDMENT) ORDER 202*

West Sussex County Council in exercise of their powers under Sections 1 (1) 2 (1) and (2), 4 (2), 45, 46, 49 and 53 and Part IV of Schedule 9 of the Road Traffic Regulation Act 1984 "the Act" as amended and of all other enabling powers and after consultation with the chief officer of police in accordance with Part III of Schedule 9 to the Act hereby make the following Order:-

1. This Order shall come into operation on the X day of X 2021 and may be cited as "West Sussex County Council ((Chichester District) (Parking Places and Traffic Regulation) (Consolidation) Order 2010) (Westgate Amendment) Order 2021."
2. The "West Sussex County Council (Chichester District) (Parking Places and Traffic Regulation) (Consolidation) Order 2010" is hereby amended by the deletion of the plan in the First Schedule to this Order and the substitution of the plan attached in the Second Schedule to this Order.

FIRST SCHEDULE
Plan to be deleted

SU8504NEN (Sheet Issue No. 6)

SECOND SCHEDULE
Plan to be substituted
(as attached)

SU8504NEN (Sheet Issue No. 7)

The COMMON SEAL of WEST SUSSEX)
COUNTY COUNCIL was hereto affixed)
)
the)
day of)
in the presence of) (L.S.)
)
)
)
Authorised Signatory)

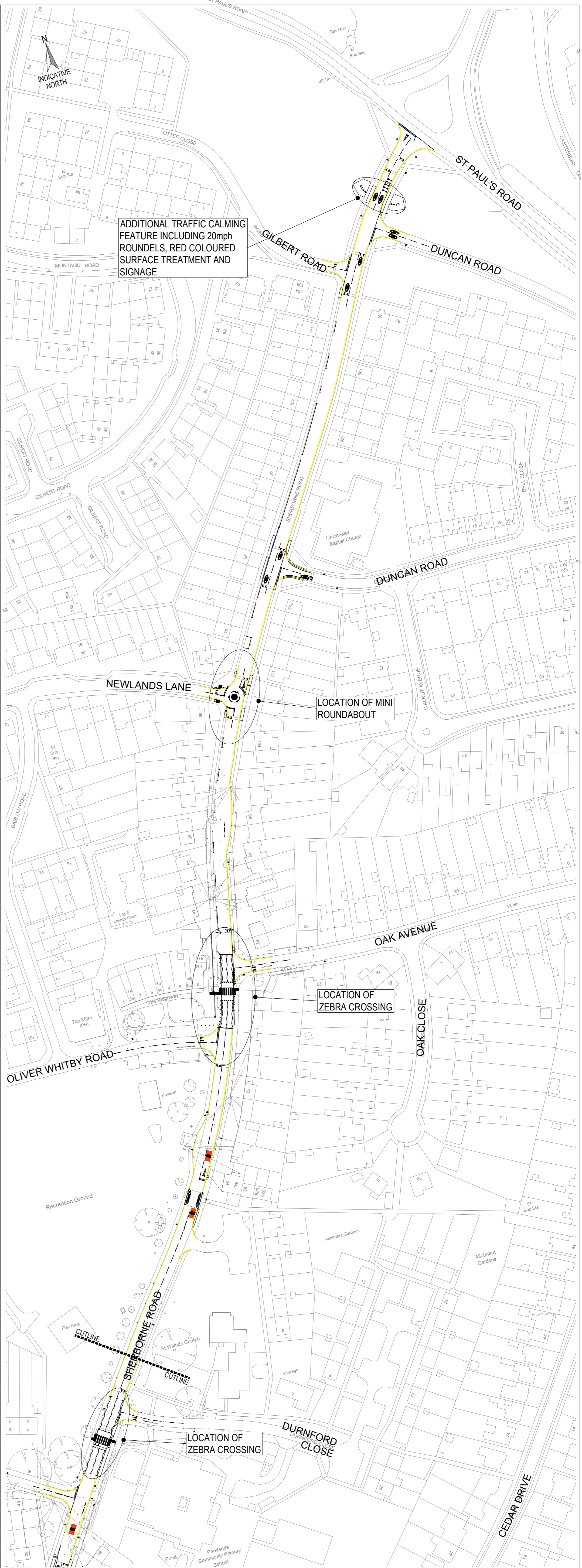
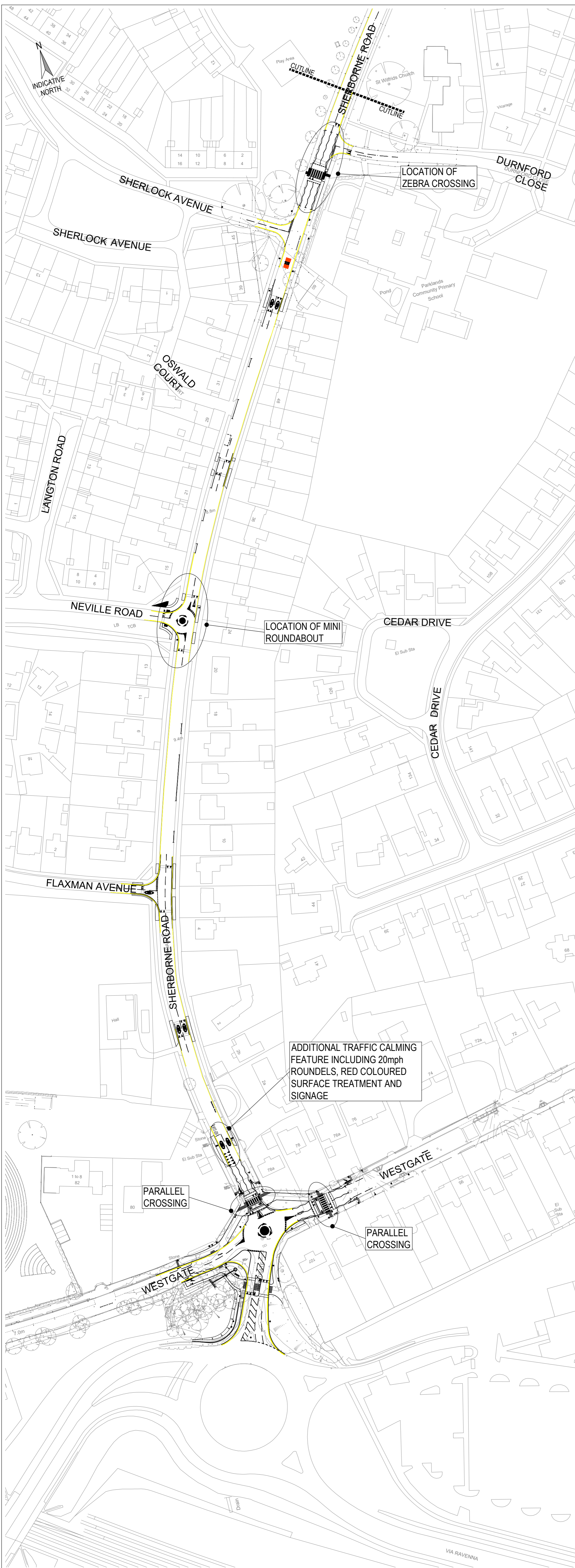

REPRODUCED FROM OR BASED UPON
 ORDNANCE SURVEY MAPPING WITH PERMISSION
 OF THE CONTROLLER OF HMSO CROWN
 COPYRIGHT RESERVED. LICENCE No. 100022432

SCALE@A1: 1:1000		PROJECT: WEST CHICHESTER S278 WORKS	
PROJECT REF: 19183		TITLE: SHERBORNE ROAD TRAFFIC ORDERS	
DRAWING No: TRO-100		REV: P1	
P1 19.04.21 FIRST Issue.	JE GS	Revision Referencing P = Preliminary A = Approval T = Tender C = Construction	
Rev Date Description	By Apvd		



- KEY**
- S278 Works Boundary
 - Existing Adopted Highway Boundary
- LEGEND**
- PROPOSED EXTENT OF TRO
 - EXISTING SIGN TO BE REMOVED OR RELOCATED
 - NEW AND EXISTING SIGNS CO-ORDINATED WITH PROPOSED 20mph SPEED LIMIT LAYOUT
 - INDICATES DIRECTION OF SPEED LIMIT

Rev	Date	Description	By	Apvd
P1	17.02.21	Preliminary Issue.	JE	GS

PROJECT:
WEST CHICHESTER S278 WORKS

TITLE:
WESTGATE / ORCHARD STREET
PROPOSED DUTCH STYLE ROUNDABOUT
20mph TRAFFIC REGULATION ORDER PLAN
CLIENT:



SCALE@A1:
1:500

PROJECT REF:
19183
DRAWING No:
WGOS - 160
REV:
P01

Revision Referencing
P = Preliminary A = Approval T = Tender C = Construction



PAGE 1 OF 2: EXISTING RESTRICTIONS ONLY

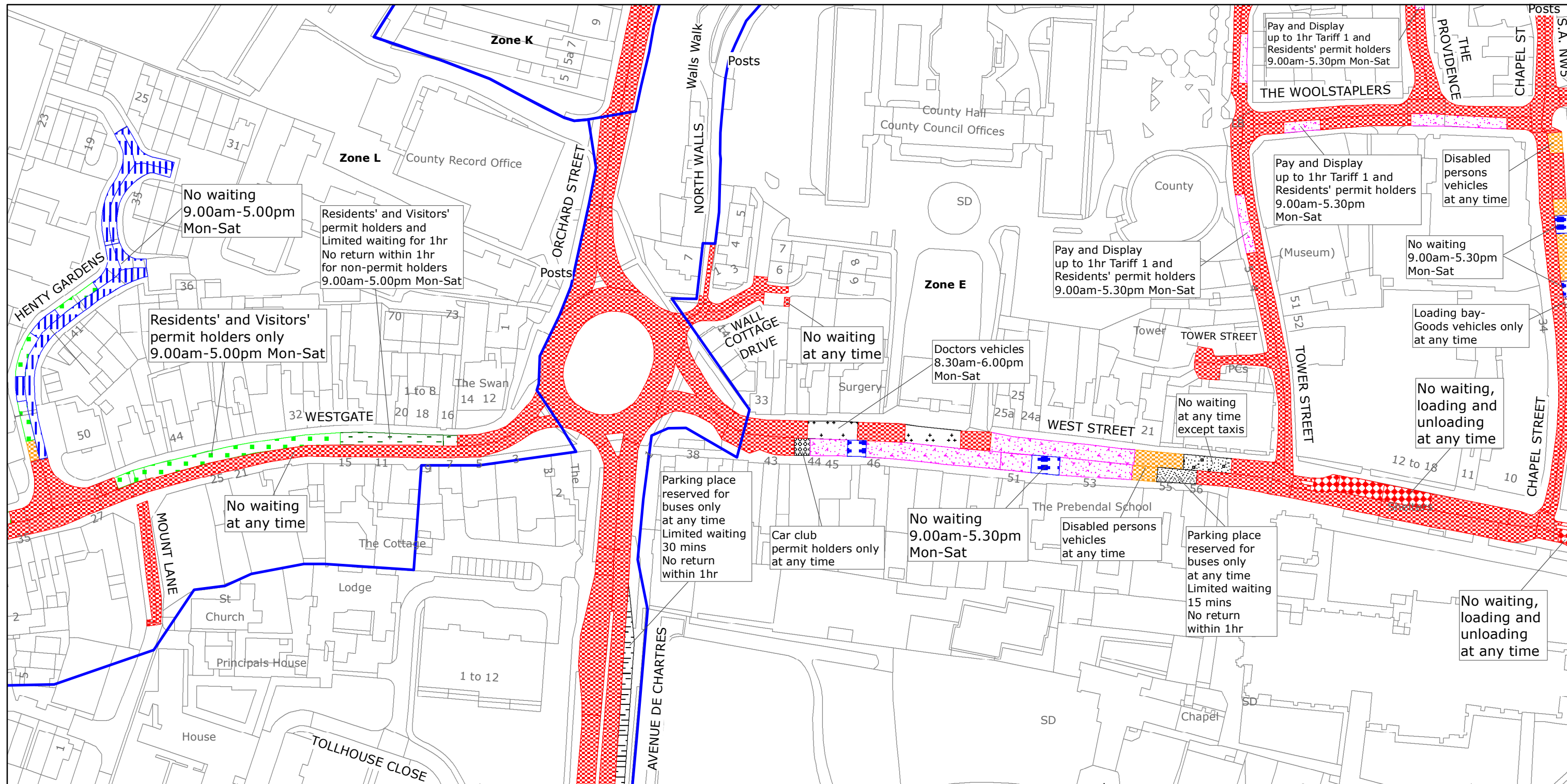

West Sussex County Council
 Highways & Transport
 The Grange
 Tower Street
 Chichester
 West Sussex
 PO19 1RH

CHICHESTER DISTRICT: CHICHESTER
 WAITING RESTRICTIONS

TILE REF NO:
 SU8504NEN

SHEET ISSUE NO 6
 SHEET ACTIVE FROM - 03/07/2017



SCALE:
 1:1250
 at A3 size

Reproduced from or based upon 2017 Ordnance Survey mapping with permission of the Controller of HMSO (c) Crown Copyright reserved.
 Unauthorised reproduction infringes Crown copyright and may lead to prosecution or civil proceedings West Sussex County Council Licence No. 100018485

PAGE 2 OF 2: PROPOSED CHANGES TO RESTRICTIONS (CIRCLED)

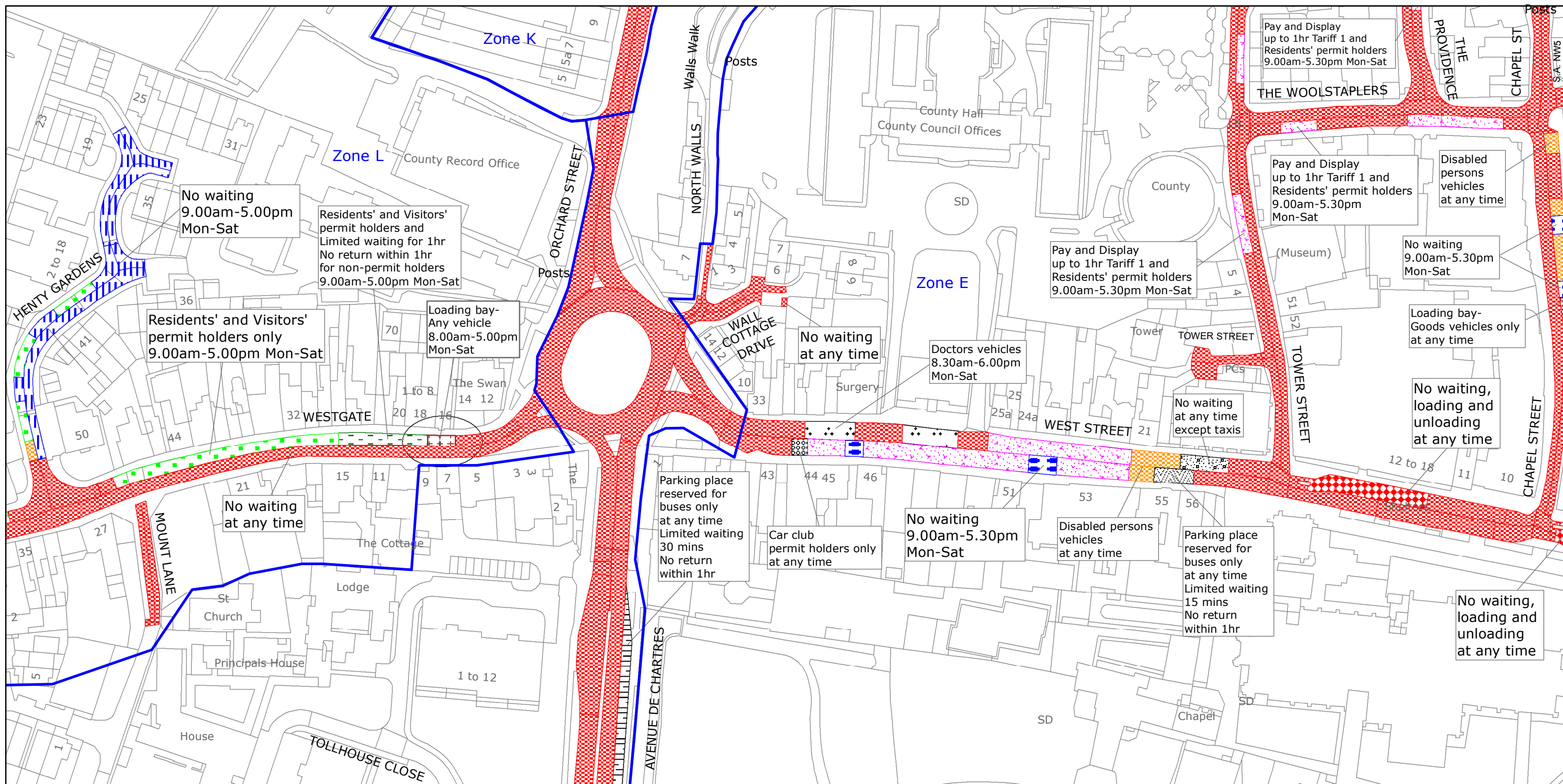

West Sussex County Council
 Highways & Transport
 The Grange
 Tower Street
 Chichester
 West Sussex
 PO19 1RH

CHICHESTER DISTRICT: CHICHESTER
 PROPOSED WAITING RESTRICTIONS (19.05.2021)

TILE REF NO:
 SU8504NEN

SHEET ISSUE NO 7_CHS9038
 SHEET ACTIVE FROM - DD/MM/YYYY



SCALE:
 1:1250
 at A3 size

Reproduced from or based upon 2021 Ordnance Survey mapping with permission of the Controller of HMSO (c) Crown Copyright reserved.
 Unauthorised reproduction infringes Crown copyright and may lead to prosecution or civil proceedings West Sussex County Council Licence No. 100018485